

Quick Reference Guide

Hardware	page 1
Top Track, Hanging Standards and Top Track Cover	page 2
Classic Hanging Drawers, Décor Drawers and Gliding Accessory Racks	page 3
Décor Shelves, Ventilated Shelves and Shelf Baskets	page 4
Décor Fascia and Closet Rods	page 5

If at any time during installation you have questions, call the store listed on your receipt or 800-733-3532. You may also visit [containerstore.com/installation](https://www.containerstore.com/installation) to view video instructions.



Wood Screw



Drywall & Plaster Anchor



Sheet Metal Screw

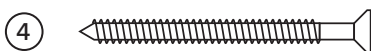

Concrete Screw

Tools needed: pencil, level, power drill, drill bit set, #2 Phillips head bit for power drill, #2 Phillips head screwdriver, hammer, tape measure, ladder or step stool, Elfa 2' spacer, plastic mallet, scissors.

TIP

- Remove all contents from your space and donate or sell all items no longer needed.
- For closets, hang clothes that you are keeping on a garment rack outside the closet during installation.
- Take out any old shelving and/or closet rods. Patch and repaint walls.
- Tape the page(s) of your custom Elfa design to the corresponding wall.
- Refer to your design for placement of your Elfa. Lay out all the products by type, size and wall.

Hardware

Based on what you have told your designer, you have been provided with the correct hardware needed to complete the installation based on your wall construction. Below are instructions for installing each type of hardware:

1 Wood Screw

Used for mounting the Top Track into drywall over wood studs or directly into wood.

Drill a hole with a 1/8" drill bit the length of the drill bit.

TIP

- Rake the wood screw over a bar of soap before inserting it into the wall. This will make tightening the screw easier.

2 Drywall & Plaster Anchor

Used for mounting the Top Track into 1/2" drywall (most common wall type) or 5/8" to 1" drywall/plaster.

Enlarge the hole with a 3/8" drill bit.

Remove the screw from the white anchor, ensuring the gray insert stays in place.

Tap the anchor into the hole with the plastic mallet.

Discard the grey spacers that are included in the packaging (not shown).

3 Sheet Metal Screw

Used for mounting the Top Track into drywall over sheet metal studs.

Drill a hole with an 1/8" drill bit the length of the sheet metal screw.

4 Concrete Screw

For concrete/masonry (cinder block or brick), drill a hole with a 5/32" masonry drill bit the length of the concrete screw.

For masonry with furring*, drill a hole with a 5/32" masonry drill bit the length of the concrete screw.

* Furring is a space usually 3/4" between the drywall and masonry surface. Furring strips are 1" x 2" pieces of wood attached to the masonry. The drywall is attached to the furring strips. When possible, the Top Track should be installed over the furring strip.

ONLY AT The Container Store®

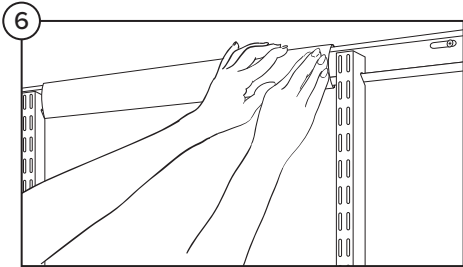
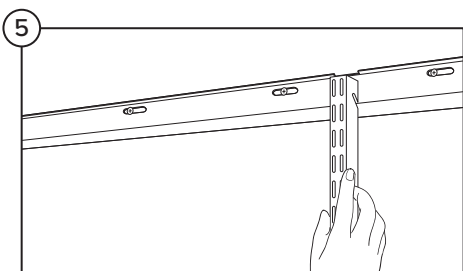
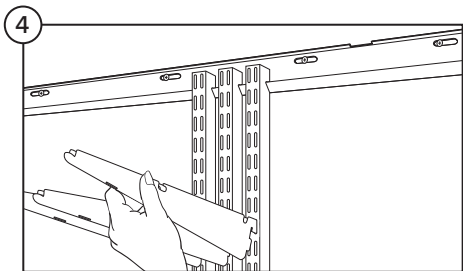
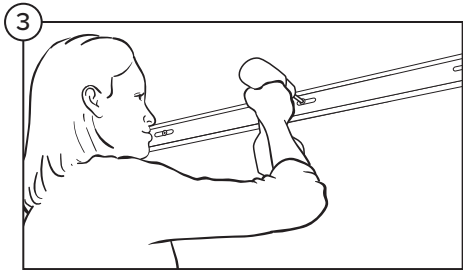
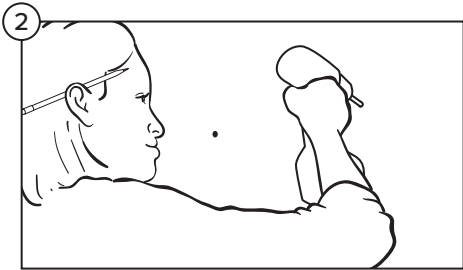
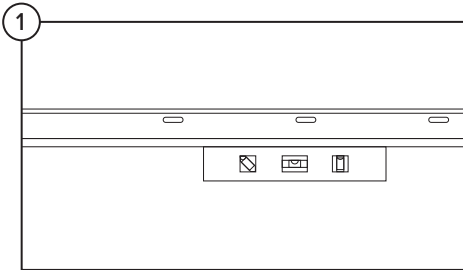

Top Track, Hanging Standards and Top Track Cover

Tools needed: drill, screwdriver, level and pencil

Install Top Track

- 1 Position the Track where you want to mount it, use a level to ensure it is straight. Using a pencil, mark each hole location. Be sure to keep Track level.

TIP

For longer Tracks, drill the center hole and secure with one screw. Tighten the screw just enough to hold the Track against the wall. Level the Track and mark the rest of the holes.

- 2 Set Track aside and drill a 1/8" hole at each location. If you hit wood, continue drilling the entire length of the drill bit. In most applications, you will not hit wood for every hole. If you don't hit a stud, mark the location. At the marked locations, enlarge that hole with the appropriate drill bit size for the hardware needed for your wall construction.
- 3 Place the Track on the wall, insert and tighten all the screws using a power drill with a #2 Phillips head bit. To avoid stripping the screws, finish hand tightening with a #2 Phillips head screwdriver.

Install Hanging Standards and Shelf Brackets

- 4 Hang Standard on Track. Group Hanging Standards together and insert Brackets at the appropriate height for desired shelf placement.
- 5 Slide the Hanging Standards to the approximate position on the Top Track. Hanging Standards should be a minimum of 1/2" from the ends of the Top Track.

Install Top Track Cover

TIP

Install your Top Track Cover ONLY after you have placed all of your components and are satisfied with positioning of your Elfa Shelving.

- 6 Start with the long pieces first. Cut Top Track Cover to size using scissors. Place top of Top Track Cover on top of the Top Track. Push the bottom part of the Top Track Cover over the bottom of the Top Track. You may need a bit of force to secure the Top Track Cover.

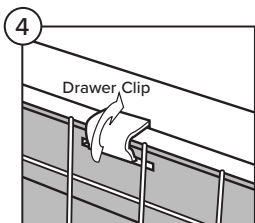
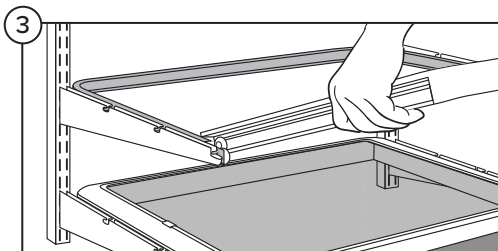
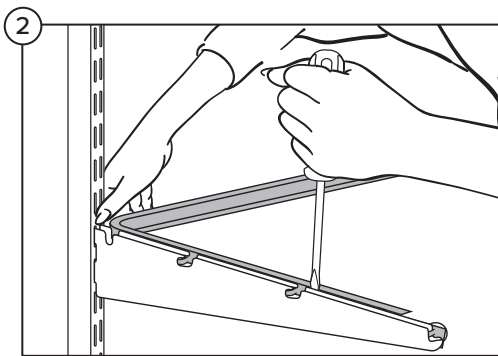
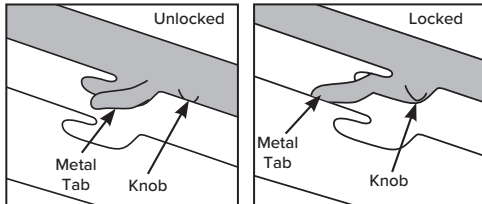
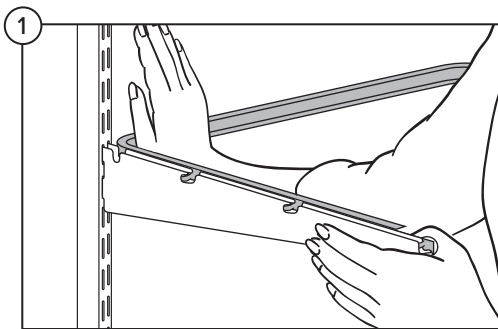

Install U-Shaped Metal Glides

TIP

- Gliding Accessory Racks, Elfa Classic Hanging Drawers and Décor Drawers are all installed with the same U-Shaped Metal Glide.
- If you would like more space between the gliding components, simply move them to the desired position.

- 1 The U-Shaped Metal Glide has three metal tabs and a metal knob on each side (located at the top of the glide) that locks the glide into the Bracket. Begin with the left Bracket. Align the metal tabs on the U-Shaped Metal Glide with the cutout notches of the Bracket. Once aligned, hold the front of the Bracket and press on the U-Shaped Metal Glide at the back rounded corner until you hear it lock into place. Repeat on the right side.

TIP

- To REPOSITION the U-Shaped Metal Glide: It is not necessary to remove the glide from the Brackets. Simply tilt up the front of both Brackets and remove them from the Hanging Standards. Place in the desired location.

- 2 To REMOVE the U-Shaped Metal Glide from the Brackets: Place one hand at the back of the glide. With your thumb on the Hanging Standard, gently push the glide forward with your fingers. At the same time, insert and twist a small flat head screwdriver between the Bracket and U-Shaped Metal Glide in front of the knob holding the glide in place. The U-Shaped Metal Glide should pop out of the Bracket. Repeat on the other side.

TIP

- Gliding accessories that are side-by-side will share a Bracket at the center.

Install Gliding Accessories

- 3 Align the rollers on each side of the frame with the openings in the U-Shaped Metal Glide. Slide the frame into the glide.

Add Drawers

- 4 Always start with the bottom Drawer and work up. For Décor Drawers, insert the Drawer into the frame opening and attach it to the left and right side of the wood frame with the provided Drawer Clips. For Classic Hanging Drawers, simply insert the Drawer into the frame opening.

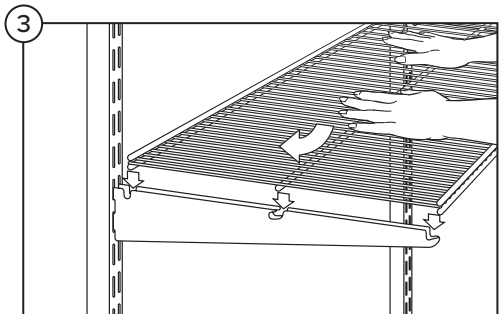
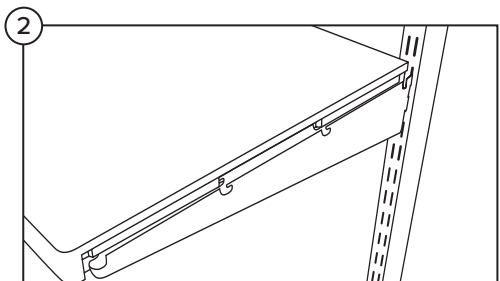
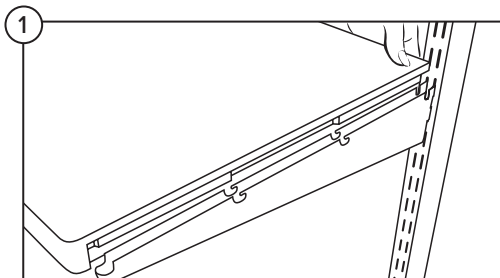

Décor Shelves

Install a Décor Shelf

- 1 Insert Ventilated Shelf Brackets into the Hanging Standards at the desired height. Place the Décor Shelf over the Brackets.
- 2 Press down to snap into place.

Ventilated Shelves

Install a Ventilated Shelf

TIP

- Install the Ventilated Shelves from shortest to longest, regardless of their location in the space.
- Ventilated Shelves have a top and a bottom. The middle support wire(s) is connected to the bottom of the Shelf.

- 3 Place the Shelf wires over Shelf Bracket notches. Install the Shelf with end wires inside the Brackets.

Lock the Shelf into place by pressing down on the middle of the Shelf and pushing toward the wall.

TIP

- To REPOSITION a Ventilated Shelf after it's been attached to the Brackets: Hold by the Brackets, and lift the front of the shelf toward the ceiling and outward to release the entire unit from the Hanging Standards. (Works on all Shelves except 20" depth.)
- To REMOVE a Ventilated Shelf from a Bracket while on the Hanging Standards: Hold the Hanging Standard steady with one hand. Place the other hand at the back of the Shelf. Pull up and forward to release.

Install Shelf Basket (not shown)

- With the double wire front lip of the Shelf Basket facing forward, place the Shelf Basket wires over the Shelf Bracket notches.
- Install the Shelf Basket with the end wires inside the Bracket.
- Lock the Shelf Basket into place by pressing down on the middle of the Shelf Basket and pushing toward the wall.
- Insert Shelf Basket Dividers where desired, if applicable.

Install Shelf Basket Fascia (not shown)

- Position the Shelf Basket fascia underneath your Shelf Baskets with the curved edges of the Shelf Basket fascia face down and parallel to the floor.
- Lift the Shelf Basket fascia up to the underside of the front edge of the installed Shelf Baskets and push back towards the wall until it clips into place.

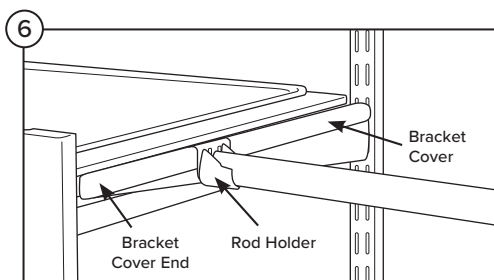
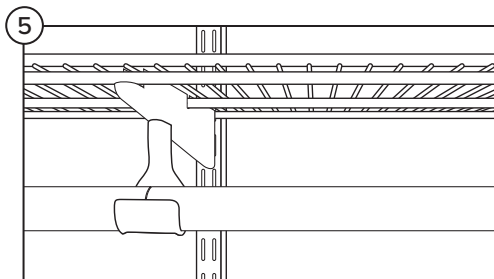
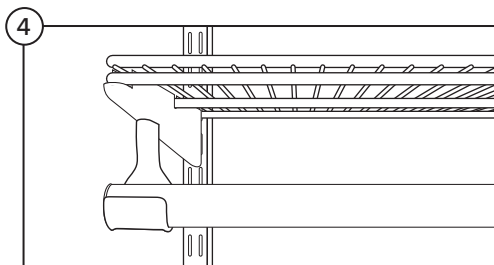
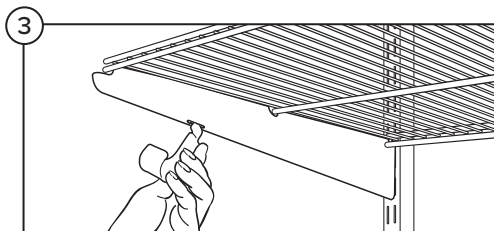
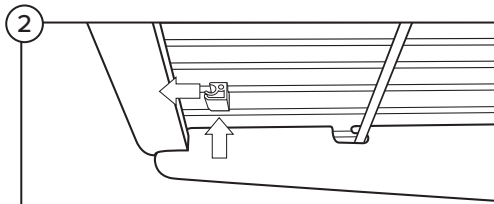
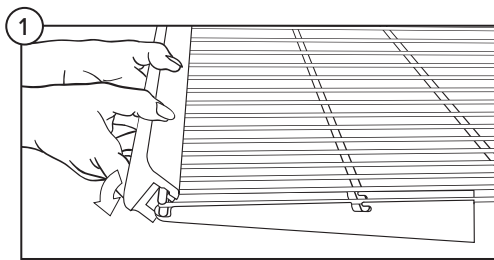

Décor Fascia

Install Décor Fascia

- 1 Position the Fascia with the opening facing the Ventilated Shelf. The notch in the Fascia that hooks onto the front support wires of the Ventilated Shelf should be at the top. Hook over the top wire with a downward motion, and secure it to the front of the Shelf.
- 2 Use the included clips to secure the Fascia to the Ventilated Shelf. The top of the clip features a groove that accommodates one shelf wire. Once it's attached to the underside of a shelf wire, slide it all the way to the front of the Shelf and into the opening of the Fascia for a secure hold. Repeat with another clip at the opposite end of the Fascia. If you are installing a 1-1/2' or 2' Fascia, add the third clip at the center of the Fascia.

Closet Rods

Install Closet Rod Holders and Closet Rods

- 3 Insert the Closet Rod Holder into the slot in the bottom of the Ventilated Shelf Bracket.
- 4 Tap the End Caps into both ends of the Closet Rod. Snap the Closet Rod into the Closet Rod Holder.

Install Closet Rods that Share a Rod Holder

- 5 First, install joined rods in the center of the Closet Rod Holder, then place the outer ends in the Closet Rod Holder. Tap the End Caps only into the non-joined ends of each Closet Rod. Adding End Caps to the joined ends creates a gap.

Install Closet Rod Adjacent to Décor Drawers

- 6 First, insert the longer part of the Bracket Cover closest to the Standard – see instructions below. Next, add the Rod Holder, then the Bracket Cover end last.

Install Bracket Covers

- Left and Right Bracket Covers are not interchangeable.
- Place the outer edge of the Bracket Cover over the outer edge of the Ventilated Shelf Bracket.
- Push down from the back to the front to snap the Bracket Cover in place.

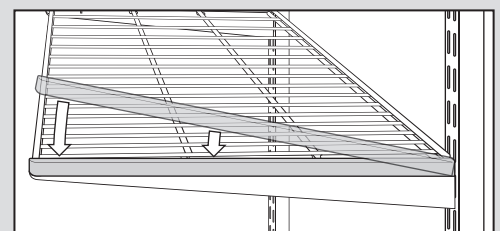

ONLY AT **The Container Store**®